

# CKL-AHP SERIES

## ALUMINIUM HIGH PRESSURE CONDENSATE SEPARATORS

operating pressure	<b>64 bar</b>
volume flow rate	<b>30 to 720 Nm<sup>3</sup>/h</b>
connections	<b>3/8" to 2"</b>
operating temp. range	<b>1,5 to 65°C</b>
surface protection	<b>anodization</b>

### APPLICATIONS

- general industrial applications
- automotive
- electronics
- food and beverage
- chemical
- petrochemical
- plastics
- paint



TD150M

page 84



TD150S

page 84



### CONDENSATE DRAINS

## DESCRIPTION

CKL-AHP condensate separators have been developed for high efficient removal of bulk liquids from compressed air systems. Inside the housing there is a condensate separator element. This element separates already liquified water from mainstream and prevents the liquids and large particles from being airborne again. To discharge condensate from the CKL-AHP condensate separator it is essential to install automatic or electronic condensate drain.



## TECHNICAL DATA - CKL-AHP CONDENSATE SEPARATORS

Filter housing size	Pipe size	Max. oper. pressure	Flow rate at 7 bar(g), 20°C		Temperature oper. range		Dimensions [mm]			Mass
	inch		bar/psi	Nm <sup>3</sup> /h	scfm	°C	°F	A	B	
CKL-AHP 005	3/8"	64/928	30	17,6	1,5 - 65	35 - 149	167	104	90	2,25
CKL-AHP 007	1/2"	64/928	60	35,3	1,5 - 65	35 - 149	167	104	90	2,25
CKL-AHP 010	3/4"	64/928	120	70,6	1,5 - 65	35 - 149	232	104	90	2,84
CKL-AHP 018	1"	64/928	180	106	1,5 - 65	35 - 149	258	150	120	6,45
CKL-AHP 030	1 1/4"	64/928	270	159	1,5 - 65	35 - 149	358	150	120	7,8
CKL-AHP 047	1 1/2"	64/928	360	212	1,5 - 65	35 - 149	458	150	120	9,17
CKL-AHP 094	2"	64/928	720	423	1,5 - 65	35 - 149	665	170	120	16,5

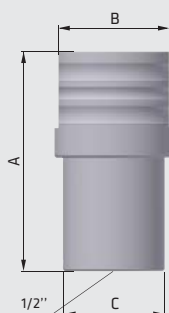

quality class - solids (ISO 8573-1)	-
quality class - water (ISO 8573-1)	8
quality class - oils (ISO 8573-1)	-
efficiency	>98%

## CORRECTION FACTORS

Operating pressure [bar]	3	5	7	10	13	16	20	30	40	50	60	64
Operating pressure [psi]	44	72	100	145	189	232	290	435	580	725	870	928
Correction factor	0,50	0,75	1	1,38	1,75	2,13	2,63	3,88	5,13	6,38	7,63	8,13