

# Flush Diaphragm Pressure Gauges

## for Food , Biological and Pharmaceutical Industry

Model 432.55

### Pressure Gauges

- Dry measuring cell, no transmission liquid
- Wetted parts and covering metallic components made of stainless steel
- Hygienic-type connection for direct, fast installation and removal
- Suitable for CIP-facilities
- Scale ranges from 0 ... 0.6 bar to -1 ... 4 bar

#### General features

The pressure gauge model 432.55 was designed as an addition to WIKA's standard range of products in order to meet the special demands made on process connections in the food, biological and pharmaceutical industry as well as in the paint and lacquer sector.

All wetted parts are made of stainless steel and fully welded.

Due to the special design of the gauge it is possible to use an absolutely dry measuring cell, thus excluding a contamination of the medium with transmission liquids that may occur on diaphragm seal systems in the case of a damage to the diaphragm.

#### Design

EN 837-3

#### Nominal size

100 and 160 mm

#### Accuracy class per EN 837-3 / 6

1.6

#### Working pressure

Steady: full scale value

Fluctuating: 0.9 x full scale value

#### Overpressure safety

1.5 x full scale value

#### Operating temperature

Ambient: -20 ... +60 °C

Medium: +150 °C maximum

#### Temperature effect

When temperature of the pressure element deviates from reference temperature (+20 °C):  
max.  $\pm 0.8\%/10$  K of true scale value

#### Ingress protection

IP 54 per EN 60 529 / IEC 529



#### Standard features

##### Process connection (exposed to pressure medium)

Stainless steel 1.4435, 2" clamp, bottom connection

##### Pressure element (exposed to pressure medium)

Welded with process connection, stainless steel 1.4435

##### Movement

Material: stainless steel

##### Dial

White aluminium with black lettering

##### Pointer

Black aluminium pointer

##### Case

Stainless steel case with pressure vent in case back

##### Window

Laminated safety glass

##### Bezel ring

Cam ring (bayonet type), stainless steel

#### Optional extras

- Process connection clamp (from 2½") resp. thread connection per DIN 11 851, SMS-Standard, IDF-Standard or APV-RJT-Standard (from DN 50 resp. 2")
- Wetted parts and covering metallic components electropolished
- Wetted parts electropolished
- Higher overpressure protection
- Connector position at 3, 9 or 12 o'clock
- Alarm contacts (see data sheet AC 08.01)

## Dimensions

### Clamp connection

Process connection	DN [in.]	Dimensions [mm]						Weight [kg]
		D	h	Ø Plf	G	d	k	
Clamp	2	100	85	48	-	64	15	0.65
		160	115					1.05
	2 ½	100	85		-	77.5	15	0.85
		160	115					1.25
	3	100	85		-	91	15	1.2
		160	115					1.6

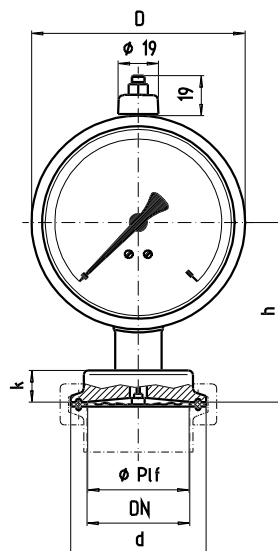

2223 554.01

### Process connection with union nut

Process connection	DN [mm or in.]	Dimensions [mm]						Weight [kg]
		D	h	Ø Plf	G	d	k	
DIN 11 851	50	100	85	48	Rd 78x1½	92	22	0.7
		160	115					1.1
	80	100	92		Rd 110x¼	127	29	1.15
		160	122					1.55
SMS-Standard	2	100	90		Rd 70x1½	84	26	0.8
		160	120					1.2
IDF-Standard	2	100	92		2" IDF	79	30	0.75
		160	122					1.15
APV-RJT-Standard	2	100	85		2 7/8x6"	86	22	0.75
		160	115					1.15

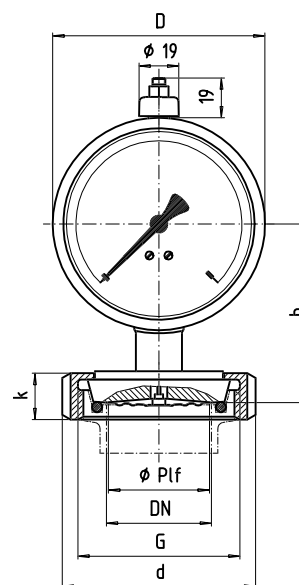

2223 311.01

### Process connection with male thread

Process connection	DN [mm or in.]	Dimensions [mm]						Weight [kg]
		D	h	Ø Plf	G	d	k	
DIN 11 851	50	100	92	48	Rd 78x1½	92	22	0.8
		160	122					1.2
SMS-Standard	2	100	98		Rd 70x1½	84	26	0.9
		160	128					1.3
IDF-Standard	2	100	98		2" IDF	79	30	0.8
		160	128					1.2
APV-RJT-Standard	2	100	92		2 7/8x6"	86	22	1.0
		160	122					1.4

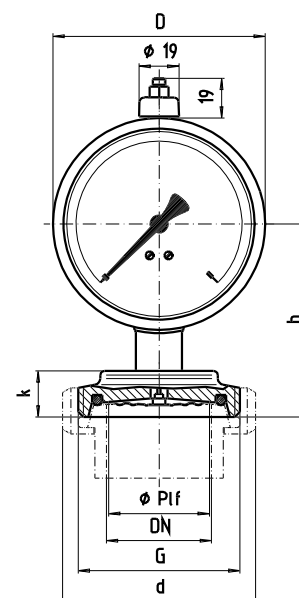

2223 520.01

## Ordering information

State:

Model / Nominal size / Scale range / Process connection (Standard, size) / Options

Specifications and dimensions given in this leaflet represent the state of engineering at the time of printing. Modifications may take place and materials specified may be replaced by others without prior notice.



**WIKA Alexander Wiegand GmbH & Co. KG**  
 Alexander-Wiegand-Straße · 63911 Klingenberg  
 Tel.: (0 93 72) 132-0 · Fax: (0 93 72) 132-406  
<http://www.wika.de> · E-mail: [info@wika.de](mailto:info@wika.de)