

# ECD-B SERIES

## ELECTRONIC CONDENSATE DRAIN

|                       |                    |
|-----------------------|--------------------|
| operating pressure    | <b>16 bar</b>      |
| drain capacity        | <b>15-150 l/h</b>  |
| inlet connection      | <b>1/2"</b>        |
| operating temp. range | <b>1,5 to 65°C</b> |



### APPLICATIONS

- air compressor (piston or screw)
- after-cooler
- cyclone condensate separator
- pressure vessel/air tank
- air filter

### ADVANTAGES

- ✓ integrated filter mesh
- ✓ compact design
- ✓ two-way connections
- ✓ eloxated housing
- ✓ contactless measuring
- ✓ direct acting, self cleaning valve (patented)
- ✓ operating diagnostic monitoring
- ✓ warning LED light for "drain operating" and "alarm"
- ✓ AC versions (for DC version please contact producer)
- ✓ robust Al housing

**PATENTED VALVE  
TECHNOLOGY**

## DESCRIPTION

ECD-B series have been developed for fully automatic discharging of condensate or any other non-aggressive fluid from compressed air<sup>(1)</sup> system. The units can be installed as external drain on any application specified.

Condensate accumulates in the collecting reservoir and when the level is high enough condensate is being discharged from the system without any air losses. Fluid level is detected by precise capacitive level sensor.

Special self-cleaning direct acting valve assures reliable operating. ECD-B series is also equipped with operation alarm, led indicator, test button and internal strainer.

ECD-B series can be used in variety of applications. For applications not listed please contact producer or your local distributor.

<sup>(1)</sup>For any other technical gas please contact producer or your local distributor.

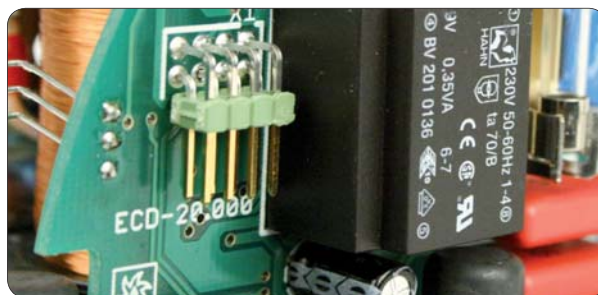

| Technical data                                    |         | ECD 15B                  | ECD 40B                  | ECD 90B                  | ECD 150B                 |
|---------------------------------------------------|---------|--------------------------|--------------------------|--------------------------|--------------------------|
| Voltage                                           | 115 VAC | 115 V ± 10 %             | 115 V ± 10 %             | 115 V ± 10 %             | 115 V ± 10 %             |
|                                                   | 230 VAC | 230 V ± 10 %             | 230 V ± 10 %             | 230 V ± 10 %             | 230 V ± 10 %             |
| Power                                             | 115 VAC | 24 VA                    | 24 VA                    | 24 VA                    | 24 VA                    |
|                                                   | 230 VAC | 24 VA                    | 24 VA                    | 24 VA                    | 24 VA                    |
| Frequency                                         |         | 50-60 Hz                 |                          |                          |                          |
| Operating pressure                                |         | 0-16 bar (0 - 232 psi)   |                          |                          |                          |
| Drain capacity (at 7 bar/101 psi)                 |         | 15 l/h (0,0088 cfm)      | 40 l/h (0,023 cfm)       | 90 l/h (0,053 cfm)       | 150 l/h (0,088 cfm)      |
| Operating temperature range                       |         | 1,5 - 65 °C (35-149 °F)  |                          |                          |                          |
| Inlet connection                                  |         | R 1/2"                   | R 1/2"                   | R 1/2"                   | R 1/2"                   |
| Outlet connection                                 |         | R 1/8"                   | R 1/8"                   | R 1/8"                   | R 1/8"                   |
| Power interface                                   |         | 3 × 0,75 mm <sup>2</sup> | 3 × 0,75 mm <sup>2</sup> | 3 × 0,75 mm <sup>2</sup> | 3 × 0,75 mm <sup>2</sup> |
| Protection class                                  |         | IP54                     | IP54                     | IP54                     | IP54                     |
| Mass [kg]                                         |         | 0,9                      | 0,9                      | 1,05                     | 1,15                     |
| Dimensions A × B × C [mm]                         |         | 120 × 82 × 125           | 120 × 82 × 125           | 120 × 82 × 135           | 120 × 82 × 150           |
| Peak compressor performance [m <sup>3</sup> /min] | a       | 11,6                     | 29,4                     | 60,6                     | 111,6                    |
|                                                   | b       | 9,3                      | 23,5                     | 48,5                     | 89,3                     |
|                                                   | c       | 5,8                      | 14,7                     | 30,3                     | 55,8                     |
| Peak dryer performance [m <sup>3</sup> /min]      | a       | 23,2                     | 58,8                     | 121,2                    | 223,2                    |
|                                                   | b       | 18,6                     | 47,0                     | 97,0                     | 178,6                    |
|                                                   | c       | 11,6                     | 29,4                     | 60,6                     | 111,6                    |
| Peak filter performance [m <sup>3</sup> /min]     | a       | 116                      | 294                      | 606                      | 1116                     |
|                                                   | b       | 93                       | 235                      | 485                      | 893                      |
|                                                   | c       | 58                       | 147                      | 303                      | 558                      |
| Compressor motor power [kW]                       |         | up to 30                 | up to 75                 | up to 160                | up to 315                |

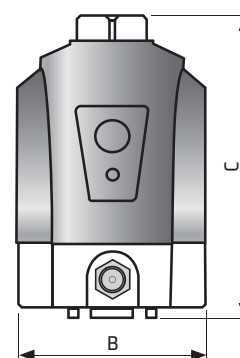
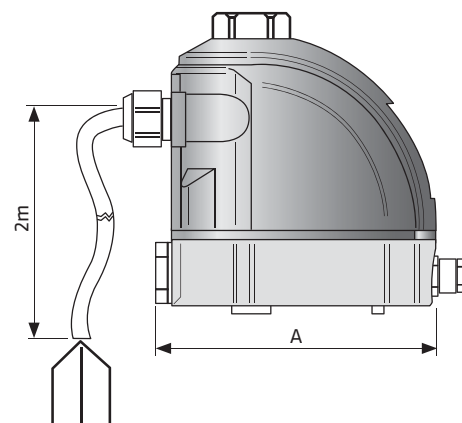

Please take the relevant climate zone into account when dimensioning yours specific ECD-B drain series application:

|   |                                                                     |
|---|---------------------------------------------------------------------|
| a | Northern Europe, Canada, Northern USA, Central Asia                 |
| b | Central and Southern Europe, Central America                        |
| c | South East Asian coastal regions, Oceania, Amazon and Congo regions |