

Flexible suction pad mountings Series NPF

The vulcanisation provides flexibility in all directions.
Thread G1/4



- » Flexible in all directions for optimal adaption to the workpiece (up to 12°)
- » Low pivoting point which reduces the wear on the suction pad.
- » Rubber covered (vulcanised) metal connection for heavy loads.

5

The flexible suction pad mounting Series NPF allows a better adaption between the suction pad and the workpiece due to its flexibility in all directions.

Applications:

- Suitable for use in conjunction with larger flat suction pads on bigger workpieces which are either inclined or have a tendency to sag during the lifting operation or simply have a slightly irregular shape.
- They can be used in combination with spring plungers for further compensation in height if needed.

GENERAL DATA

Description	Flexible suction pad mounting
Materials	<ul style="list-style-type: none">- Steel body- Vulcanised rubber connection

CODING EXAMPLE

NPF	-	FM	-	1/4	-	M10 X 1,25
-----	---	----	---	-----	---	------------

NPF

SERIES
NPF = Flexible suction pad mountings

FM

THREAD VERSION
FM = G1 Female / G2 Male

1/4

FEMALE THREAD G1
1/4 = G1/4

M10x1,25

MALE THREAD G2
M10x1,25 = M10x1,25
1/4 = G1/4

5

VACUUM

Flexible suction pad mountings Series NPF

* G1 = Female thread (F)

** G2 = Male thread (M)

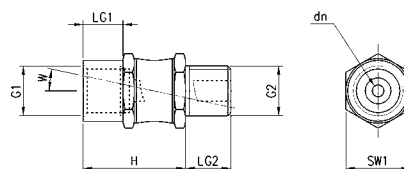

DIMENSIONS

Mod.	dn	G1 *	G2 **	H	LG1	LG2	SW1	W(°)	Vertical load (N)	Bending moment (Nm)	Weight (g)
NPF-FM-1/4-M10X1,25	2,8	G1/4 F	M10X1,25 M	27	10,5	8	17	12	500	8	26
NPF-FM-1/4-1/4	3	G1/4 F	G1/4 M	27	12	12	17	12	750	10	30