

Check valves Series VNV

These check valves are mainly used on vacuum gripper systems containing multiple suction pads in order to shut off individual suction pads which are not covered.

Thread size M5, G1/8, G1/4, G3/8, G1/2.

» Enable the de-activation of suction pads not in contact with the workpiece, thus makes it possible to create more versatile “multi use” gripping system.

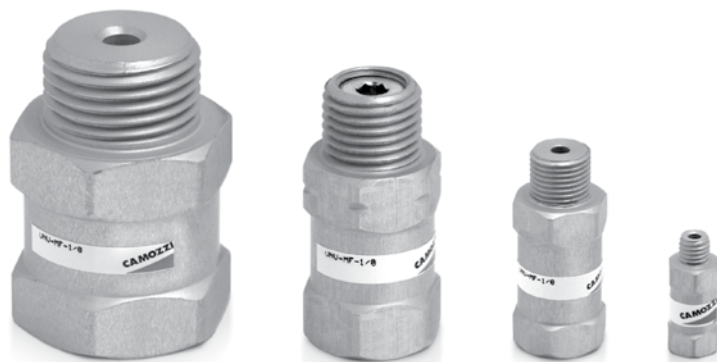

The check valves Series VNV are mainly used on vacuum gripper systems containing multiple suction pads in order to shut off individual suction pads which are not covered or accidentally pulled away from the workpiece. In this way the gripper system can operate correctly maintaining the vacuum level necessary for the application.

Applications:

- Handling objects with different shape and dimensions with the same gripping system

GENERAL DATA

Description

- ball seat valve with fixed bypass function
- aluminium body with internal elements in brass
- integrated dirt filter

TECHNICAL DATA

Required suction rate

Mod.	- 0,3 bar (m3/h)	- 0,3 bar (l/min)	- 0,6 bar (m3/h)	- 0,6 bar (l/min)	Max flow rate (m3/h)	Max flow rate (l/min)	Weight (g)
VNV-MF-M5	0,12	2	0,22	3,7	2,3	38,3	2,2
VNV-MF-1/8	0,22	3,7	0,43	7,2	15,7	261,7	11,2
VNV-MF-1/4	0,24	4	0,47	7,8	21,9	365	17,5
VNV-MF-1/2	0,7	11,7	1,4	23,3	37	616,7	47,4
VNV-MF-1/8	0,22	3,7	0,43	7,2	15,7	261,7	11,2
VNV-MF-1/4	0,24	4	0,47	7,8	21,9	365	17,5
VNV-MF-1/2	0,7	11,7	1,4	23,3	37	616,7	47,4

CODING EXAMPLE

VNV	-	MF	-	M5
------------	---	-----------	---	-----------

VNV	SERIES VNV = Check valve
MF	THREAD VERSION MF= G1 male / G2 female FM = G1 female / G2 male
M5	THREAD M5 = M5 1/8 = G1/8 1/4 = G1/4 1/2 = G1/2

5

VACUUM

VNV from M5 to G1/2

Thread version: Female - Male



* M = Male
* F = Female

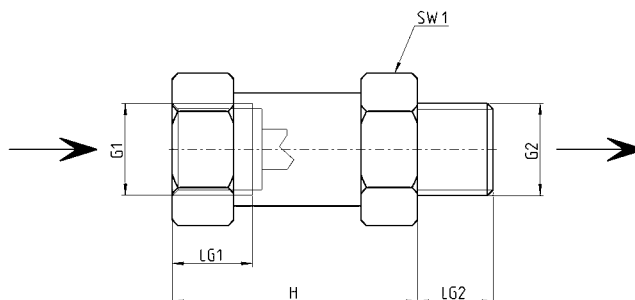

DIMENSIONS

Mod.	G1*	G2*	H	LG1	LG2	SW1
VNV-MF-M5	M 5 F	M 5 M	15,5	4,5	4,5	8
VNV-MF-1/8	G1/8 F	G1/8 M	26	8	8,5	14
VNV-MF-1/4	G1/4 F	G1/4 M	26	10	11	17
VNV-MF-1/2	G1/2 F	G1/2 M	29	12	14	27

VNV from G1/8 to G1/2

Thread version: Male - Female



* M = Male
* F = Female

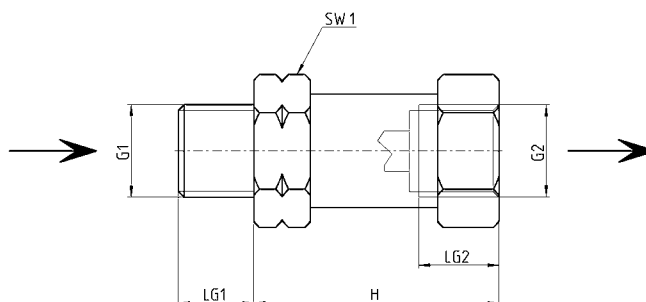

DIMENSIONS

Mod.	G1*	G2*	H	LG1	LG2	SW1
VNV-FM-1/8	G1/8 M	G1/8 F	26	8,5	8	14
VNV-FM-1/4	G1/4 M	G1/4 F	26	11	10	17
VNV-FM-1/2	G1/2 M	G1/2 F	29	14	12	27